

COM		INVERNESS INFO
ATIS	109.200 (VOR INS)	INVERNESS TOWER
TWR	118.405	INVERNESS FIRE
LIGHTING		
APCH 05/23	HI 900 m with 5 bars.	
THR 05/23	HI green with green W bars.	
RWY 05/23	HI white final 600 m yellow. End lights red.	
TWY		
Blue edge between THR 05 and THR 11 (via aprons).		
Green CL from RWY 05/23 to SAR Apron.		
Green CL from Hold F through North Apron and taxiway to South Apron.		
Guard lights and stop bars at Holds A1, F and G.		

Hot Spots
HS1
Holding point E1 Vehicle Crossing
Point and entry to Runway 11.
Helicopters may land/depart 11
Threshold.
HS2
Holding point F entry to main
Runway. Red stop bars.

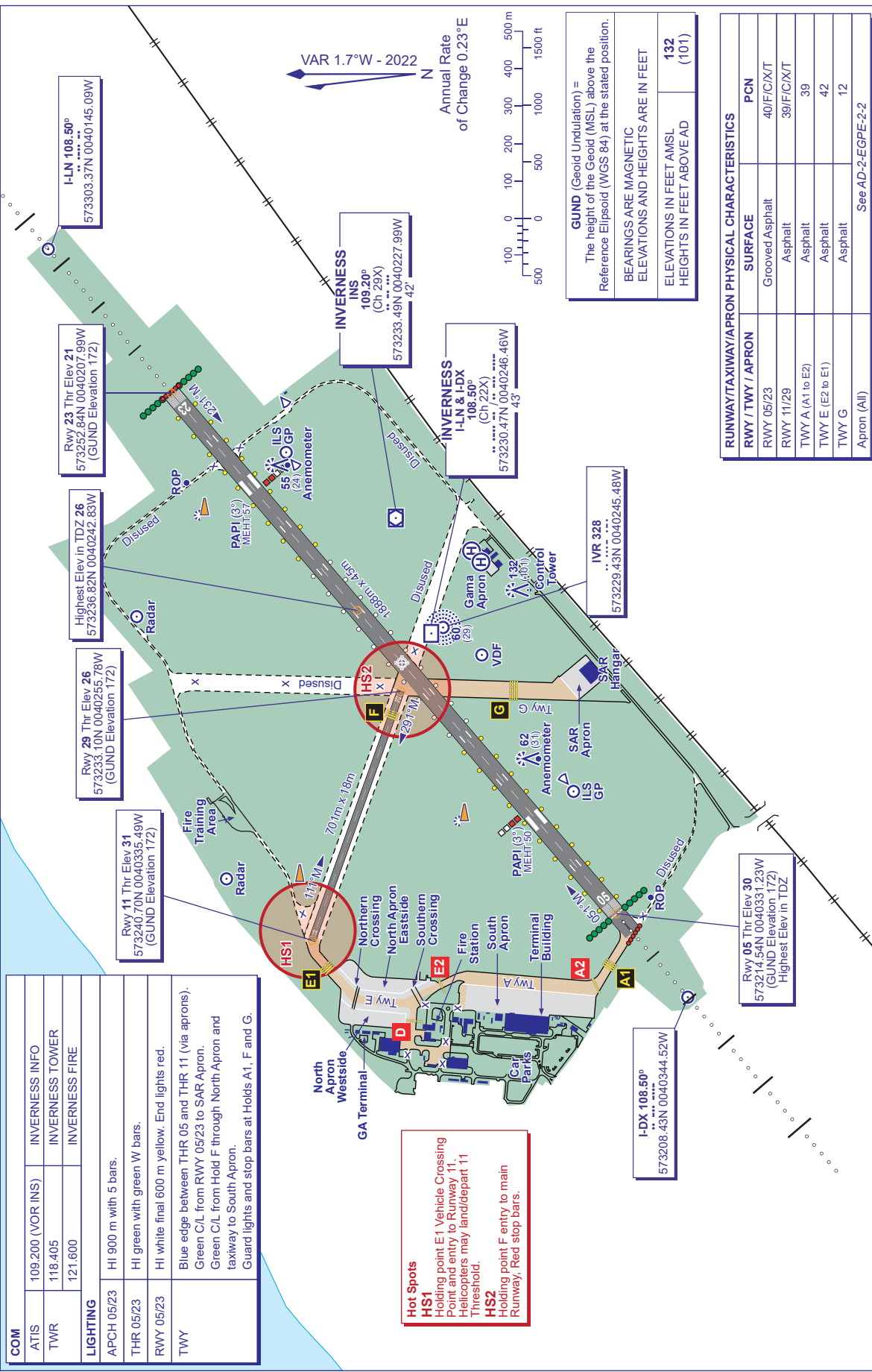

GUND (Geoid Undulation) = The height of the Geoid (MSL) above the Reference Ellipsoid (WGS 84) at the stated position.	
BEARINGS ARE MAGNETIC ELEVATIONS AND HEIGHTS ARE IN FEET	132 (101)
ELEVATIONS IN FEET AMSL	
HEIGHTS IN FEET ABOVE AD	

RUNWAY/TAXIWAY/APRON PHYSICAL CHARACTERISTICS		
RWY / TWY / APRON	SURFACE	PCN
RWY 05/23	Grooved Asphalt	40/F/C/X/T
RWY 11/29	Asphalt	39/F/C/X/T
TWY A (A1 to E2)	Asphalt	39
TWY E (E2 to E1)	Asphalt	42
TWY G	Asphalt	12
Apron (All)		See AD-2-EGPE-2-2